

## Stainless steel wall-mounted lever-operated liquid soap dispenser

References: **BO-26607** / **BO-26617**



### Description

Wall-mounted liquid soap dispenser in brushed stainless steel, available with direct filling or with soap cartridge.

Dispensing through stainless steel lever.

Vandal-proof.

Suitable for PRM.

### Features

AISI 304 bacteriostatic stainless steel, brushed finish, 0,8 mm thickness. Welded, rounded and smooth angles.

0,5L or 1L capacity.

For all types of PH-neutral liquid soap.

Soap level control slot.

Key lock.

Fixings supplied.

Dimensions:

0,5L version = W96 x D153 x H297 mm (310mm projection)

1L version = W96 x D153 x H336 mm (337mm projection)

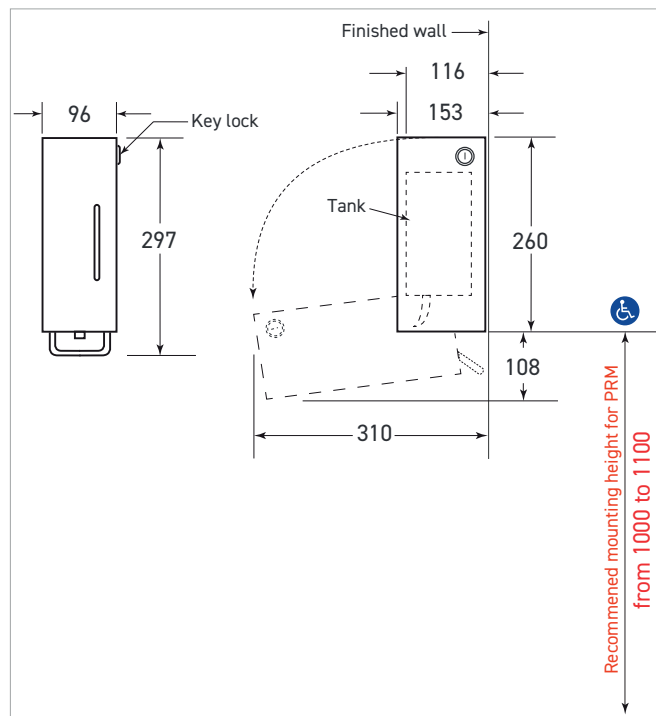

### References

- **BO-26607** 0,5L capacity
- **BO-26617** 1L capacity