

## I-CARO electronic urinal support frame

References: **DUS-50-KE/ DUS-51-KE**

### Description

Metal urinal support frame with integrated I-CARO electronic faucet for automatic rinsing upon user departure.

AISI 316 brushed stainless steel vandal-proof front (marine grade, ideal for humid environments, offering superior corrosion resistance).

Comfort: Touch-free operation and elimination of odors through automatic rinsing after each use.

High water savings.

Minimalist style for a sleek, modern restroom design.

### Features

Self-adjusting infrared detection. Adjustable parameters by remote control (flush duration, detection range, activation delay, temporary stop, periodic rinsing, etc.).

Powered by 9 V battery or 230/9 V transformer.

Low battery indicator light for replacement.

Automatic rinse if not used for 24 h (keeps trap filled with water, reduces risk of freezing, fights bacterial growth).

Optional pre-rinse function.

Vandal-proof AISI 316 brushed stainless steel front panel.

Dim. W140 x H140 mm.

In-wall housing with shut-off valve (flow adjustment), solenoid valve and filter. Battery box for battery version.

Detection range: 600 mm (adjustable).

Flush time: 6 seconds (adjustable).

Flush 1.89 L / Eco flush option 0.5 L.

Cold water inlet M1/2" or M3/4"; outlet F1/2".

Pressure: 0.5 to 8 bars.

Epoxy-galvanized steel support frame including all accessories and fixings, for light or solid walls.

C-profile frame 40/40 mm.

Adjustable 1140 to 1340 mm frame height.

Height-adjustable galvanized feet 0-200 mm, swiveling.

Urinal fixing by 2 M8 rods

Elbow drain pipe Ø 50 mm

CE. 3-year warranty

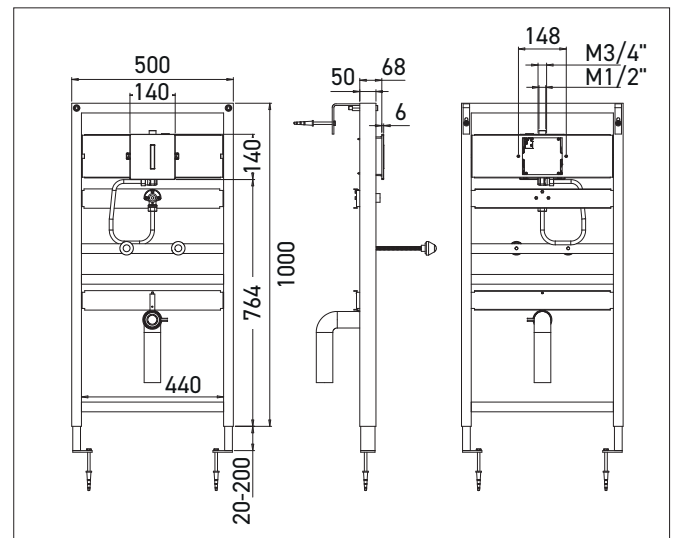

### References model choices

I-CARO urinal support frame

- **DUS-50-KE**     **9 V battery**
- **DUS-51-KE**     **230/9 V transformer**

### Options

- RES-31     Remote control
- RES-294     IP68 transformer to supply up to 4 faucets
- RES-295     Junction box to supply up to 10 faucets