

RIVAGE wall mounted Solid Surface washbasin

References: **LVA-600** / **LVA-1200** / **LVA-1800**



Ref. LVA-600



Ref. LVA-1200

Description

RIVAGE wall-mounted white Solid Surface washbasin with hidden drainage system.

Thin 70 mm rear deck for wall-mounted faucets or 3 in 1 mirror cabinets.

Hygiene: all rounded internal corners and a fully accessible drain channel for easy, thorough cleaning.

Resistance: very strong material, resistant to impact, scratches and wear.

Modern, sleek and functional design.

PRM access.

Solid Surface washbasins are particularly well-suited for high-traffic public washrooms and high-end spaces.

Features

Solid Surface wall-mounted vanity top with washbasin and no visible joints, smooth non-porous surface, matte white finish.

Sloped basin to prevent water from collecting and ensure complete drainage.

Gently rounded internal corners for easy maintenance and increased durability.

Wall-mounted basin support with trap cover or brackets (optional).

1 1/4" concealed drainage.

Dim. W600 / W1200 / W1800 x D500 x H100 mm

CE. 5 year warranty.

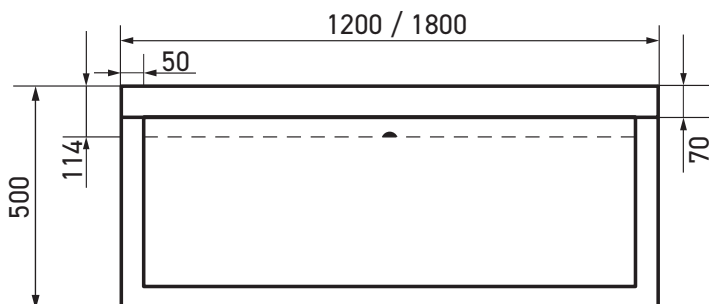
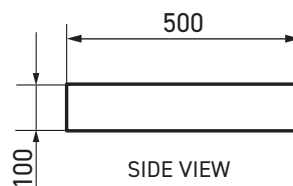
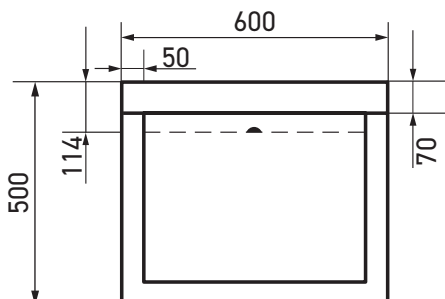

References model choices

Wall mounted Solid Surface washbasin

- **LVA-600** 600 mm wide
- **LVA-1200** 1200 mm wide
- **LVA-1800** 1800 mm wide

Options

- Brackets, trap cover or basin unit
- Faucet hole(s) Ø 22 mm (Ref.: ...-T2) or 35 mm (Ref.: ...-T1)
- Soap dispenser hole(s)
- Backsplash H220 or H250mm (Ref.:...-D)

