

AKWA 2M wall-mounted electronic thermostatic mixing tap

Reference: **RES-250** / **RES-251**

Description

Automatic wall-mounted thermostatic faucet specially designed for hospitals, clinics, nurseries, etc.

PROXI version: Water is activated by user approach and lasts for the duration of their presence.

The thermostatic control delivers the exact temperature desired without touching the faucet.

The low swivel spout prevents water from stagnating inside.



Features

Self-adjusting infrared sensor with optimized presets or adjustable with remote control (detection range, flow duration, flow delay).

Powered by 9V battery or 230/9V transformer.

Sensor includes a low battery LED indicator.

Security stop after 600 seconds without interruption (adjustable from 60 to 1200 seconds).

Sensor range 420 mm (adjustable from 290 to 680 mm).

Operating pressure: 0.3 – 8.0 bars. / Max. temperature 70°C.

Integrated solenoid valve.

Flow-limiting aerator 6 LPM. On demand, 3 LPM.

Off-center connectors and finishing rosettes provided.

CE. ACS. 3 year warranty.

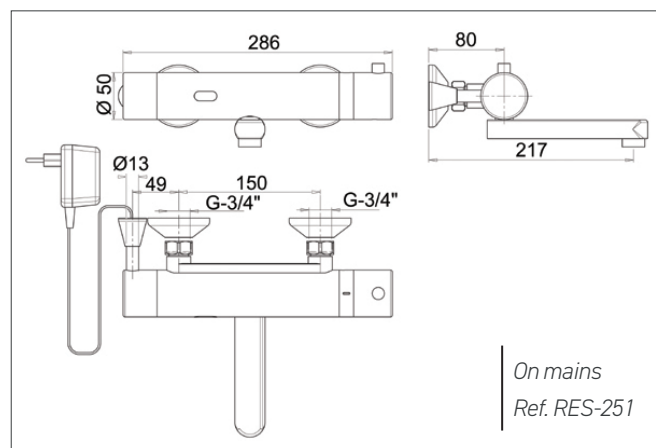
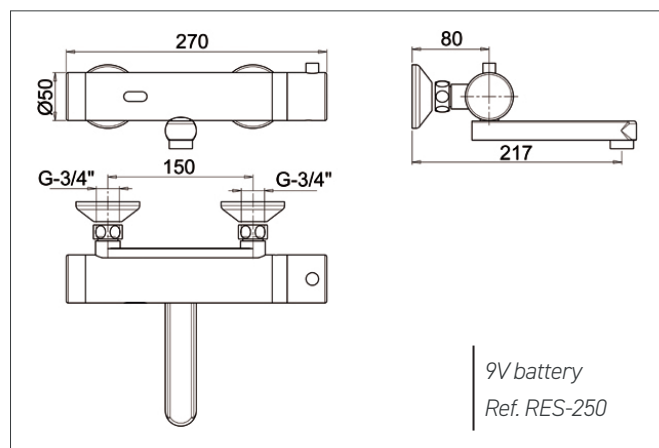

References model choices

AKWA 2M electronic mixer tap

- **RES-250** 9V battery
- **RES-251** 9V transformer

Option

- RES-31 Remote control
- RES-258 Fixed inclined spout version
- RES-254 Gooseneck spout version
- Limited 3 LPM flow

