

ELITE electronic faucet

References: **RES-74 / RES-75 / RES-76 / RES-77**

Description

Deck mounted electronic faucet with infrared detection.

The vandal-proof brass construction allows for safe installation in high-risk areas.

Its elegant design adds a contemporary and polished touch to sanitary spaces.

Engineered for effortless installation and upkeep, with all components integrated into its structure.

Under basin battery access.

Electronic faucets reduce water consumption, save energy and optimise sanitary hygiene.



Features

Infrared sensor with optimised presets, adjustable with remote control (detection range, flow duration, periodic flushing, temporary stop...).

Powered by 9V battery or 230/9V transformer.

Sensor includes a low battery LED indicator.

Security stop after 90 seconds without interruption.

Periodic hygiene rinse.

Chrome-plated brass body.

Adjustable NEOPERL aerator to optimise jet direction, with limited flow rate of 6 LPM (3 LPM, 1.9 LPM or 1.3 LPM on demand).

SPEX F3/8" hoses (resistant to chlorinated disinfection and temperature increases) with integrated check valves.

Supplied filters.

Mixes hot and cold water, with the solenoid valve integrated into the faucet body.

Operating pressure: 0.3 – 8.0 bars. / Max. temperature 70°C.

CE. ACS. 3 year warranty.

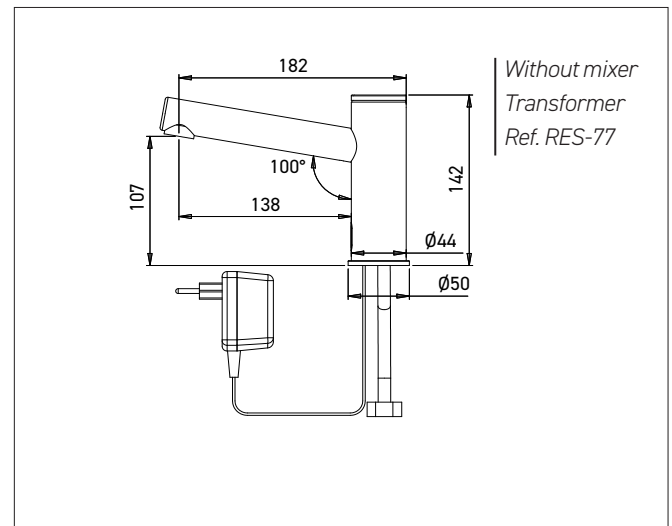
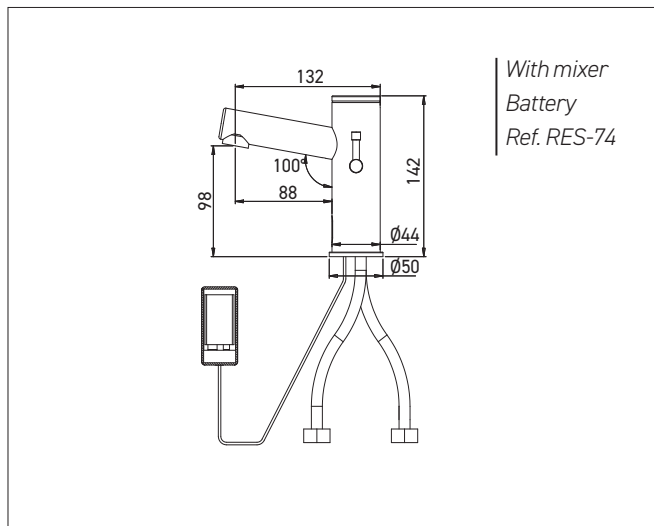

References model choices

ELITE electronic faucet

- **RES-74** with mixer, 9V battery
- **RES-75** without mixer, 9V battery
- **RES-76** with mixer 230/9V transformer
- **RES-77** without mixer, 230/9V transformer

Options

- RES-31 remote control
- Finishes matte black, PVD Brushed Nickel, PVD matte gold Antique Bronze, PVD Copper (contact us)
- Brushed AISI 316 stainless steel finish
- Limited flow rate: 1.3, 1.9 or 3 LPM
- R extended version of 200 mm (45, 110 or 163 mm on demand) and longer L version spout of 138 mm
- RES-294 IP 68 transformer to supply up to 4 faucets
- RES-295 Junction box to supply up to 10 faucets
- ...-MH Extended PRM lever