

## HYFLO 4 in 1 Mirror-Soap-Water-Air-Paper cabinet

Reference: **RES-854**



### Description

The HYFLO multifunction mirror cabinet is a practical all-in-one solution featuring an automatic liquid or foam soap dispenser, an electronic faucet with thermostatic premixer, a touch-free high-speed hand dryer and a paper towel dispenser.

The mirror cabinet with its integrated equipment is the ideal solution:

- For hygiene and comfort with the touch-free automatic activation.
- For water, soap and energy savings.
- For architectural integration by minimising the visual aspect.
- For interior space optimization and modular alignment of units.
- For easier soap filling and maintenance, with quick access.
- For vandalism protection. Completely enclosed, it prevents removal and theft.
- For its durability thanks to the quality of the materials and components.
- For a clean room: invisible faucets, hands dried without moving and the water draining directly into the washbasin.
- For easier installation and fewer people involved.
- Sleek and refined, the hidden appliances bring a minimalist and functional design.

Installation: the unit is easy to mount on the wall thanks to its stainless steel suspension rail. It requires only a single power supply line, and the water lines simply connect to the mixing valve, for a quick and ready-to-use installation.

All the components (solenoid valve, pump, sensors, transformer, stopcock, mixing valve...) within reach for ease of maintenance.

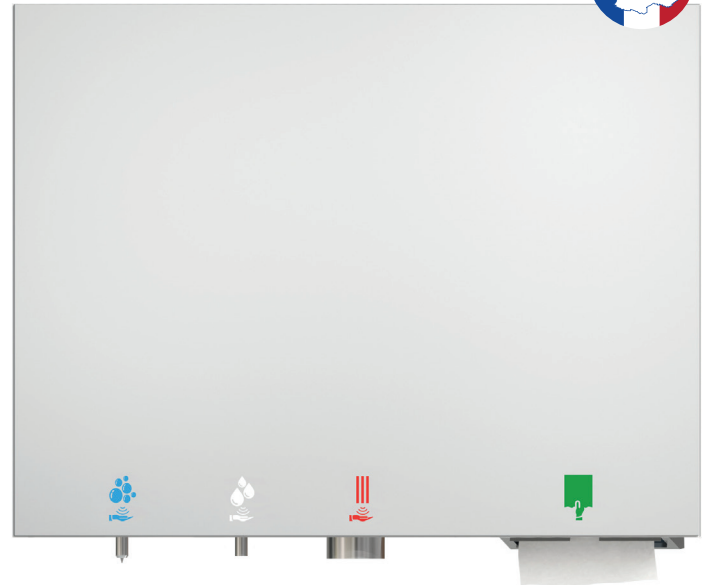

### Features

Cabinet made out of 19 mm thick white water-resistant melamine panel, 1 mm thick white PVC-coated edges, **cabinet base and door in rot-proof 19 mm white komacel. 6 mm thick mirror with backing film.** Lift-up door with 2 stay supports and 2 concealed hinges.

**Components mounted on a robust 1.2 mm thick stainless steel plate.** Key lock and automatic closure.

- Illuminated pictograms (color selection: blue, white, red, or green), french/english inscription, logo for hand detection from below, **vertical spouts and visible stainless steel nozzle to indicate hand placement in public spaces and to facilitate use.**
- Soap dispenser operates with peristaltic pump for precise soap dosage. Closes automatically without dripping.  
**7L soap tank** easily accessible for filling, liquid or foam soap.  
Liquid soap viscosity 100-3800 cPs, foam soap viscosity 0-100 cPs. PH 5.5 to 8.5.
- F3/8" thermostatic mixing valve for tempered water (without on demand).
- Vertical faucet with self-adjusting infrared detection, 6 LPM flow rate (1,9 LPM on demand).  
Security stop after 90 seconds without interruption. Water pressure: 0.5-8 bars. Periodic hygiene rinse to prevent Legionnaires' disease.
- High speed hand dryer 920W nominal output (mini. setting 350W). Hot/ambient air switch. White finished steel cover.  
**Hands dried in 9 seconds** (according to UL PCR hand dryer standard). Adjustable airflow and sound level (67.4-71.2 dB at 1m).
- **Stainless steel top-filling paper towel dispenser.** Approximate capacity: 500 towels.
- CE. 3-year warranty.
- Dimensions: W900 x D256 x H700 mm.

This concept is flexible in terms of dimensions, finishes and integrated components, please contact us.

### References model selection

- **RES-854** Liquid soap
- **RES-854M** Foam soap

#### EASY SOAP SERVICING:

- no lid to unscrew, simple flap
- no hose, prevents soap from leaking
- large bottleneck, no funnel needed
- 7L large capacity, reduces interventions

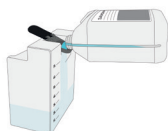

### Options

- Limited 1,9LPM flow rate
- Water and soap RES-30 remote control
- Paper towel dispenser
- White LEDs only
- Visual low soap level indicator
- Hand dryer with HEPA filter and brushless motor
- Magnetic lock (without key turn)
- LED strip on top and/or bottom of the cabinet, with or without motion sensor
- Top mirror casing H300 mm for total mirror unit height 1000mm (Ref. MH)
- Choice of mirror cabinet components
- Cabinet color finish