

CAPRINO rimless automatic urinal

References: **S49RZ** / **S49RS** / **S49RB**



Description

CAPRINO wall-mounted rimless urinal with automatic radar technology, fully concealed behind the ceramic and triggered only by use of the urinal.

With concealed fixings and a rimless design, the urinal gains a slimmer profile, giving it a modern, light, and elegant appearance.

The water distributor rinses the entire bowl, making it even more hygienic and easy to clean.

The hidden flushing system is protected against vandalism, with no contact with water, urine, or cleaning products, ensuring long service life.

This conical-shaped urinal features a 1-liter automatic syphonic flush, saving water and helping prevent unpleasant odors.

Quick **"Plug and Play"** installation with radar detection integrated into the ceramic = simply mount, connect, and the urinal is operational.

ECO modes for significant water savings:

ECO 1: Reduces the number of flushes during periods of heavy use (schools, venues, stadiums...).

ECO 2: The urinal flushes after each use, but not always with the same amount of water.

Settings adjustable based on usage frequency.

Bluetooth control included:

Downloadable app for easy configuration of urinal functions via phone, tablet, etc.

Features

White ceramic urinal with syphonic action.

Radar detection concealed within the urinal, triggered only during use (the system does not detect movement around the urinal, only liquid movement on the urinal surface).

Settings adjustable via SLD04 remote control (no need to dismantle the urinal) or Bluetooth app (detection sensitivity, flush duration, periodic flush, pre-flush and post-flush, on/off...).

Powered by 6V batteries (4 x 1.5V AA alkaline), integrated 230V mains supply, or external 230V/24V transformer.

Power consumption: 6V = 3 W, 24V = 8 W.

Low battery indicator. Accessible from below without dismantling the urinal.

Economical 1L flush (adjustable from 0.5L to 3L).

Flush duration adjustable from 0.5 to 15.5 seconds.

Minimum usage time before activation adjustable from 6 to 15 sec.

Automatic flush after 6 hours of non-use.

Overflow protection.

Trap water refills after each flush.

Water pressure 1–6 bar. Flow rate 18 LPM, adjustable via stop valve.

Rear water inlet M $\frac{1}{2}$ " threaded, waste outlet Ø50 mm.

Angle stop valve and filter, M1/2" coupling included.

Dimensions: W320 x H645 x D350 mm. Weight: 18 kg.

CE certified. Electronics guaranteed for 5 years.

References model choices

CAPRINO rimless ceramic urinal

- **S49RZ** 230V integrated mains supply
- **S49RS** 24V external transformer
- **S49RB** battery powered

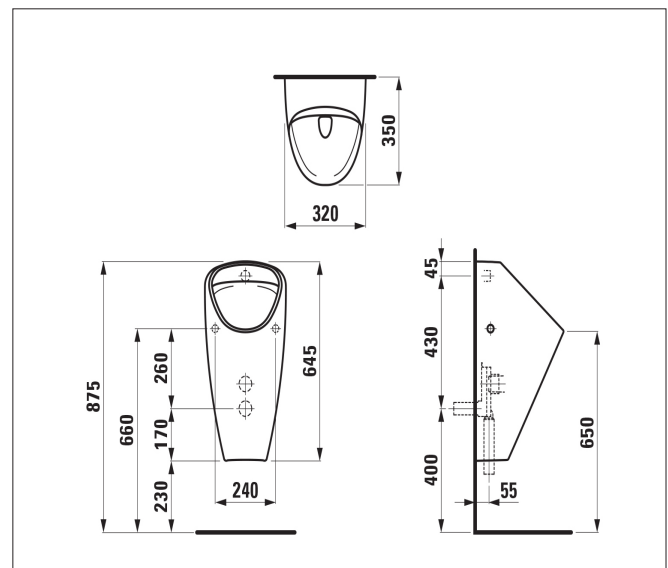

Options

- SLD04 Remote control
- SPZ06 230/24V transformer box for 1 urinal
- SPZ02 230/24V transformer box for max 5 urinals
- SPZ01 230/24V transformer box for max 9 urinals
- Bluetooth application on App Store or Play Store

