

LEMA rimless automatic urinal

References: **S59RZ** / **S59RS** / **S59RB**



Description

LEMA wall-mounted rimless urinal with automatic radar technology, fully concealed behind the ceramic and triggered only by use of the urinal.

Simplified cleaning and a guiding relief direct water flow to rinse the entire bowl.

Minimalist design, only the urinal is visible.

The hidden flushing system is protected against vandalism, with no contact with water, urine, or cleaning products, ensuring long service life.

Removable trap accessible from above without dismantling the urinal, unlocked with a special key for easy access to the drainage system. This fast and easy access helps reduce maintenance costs in public washrooms.

ECO modes for significant water savings:

ECO 1: Reduces the number of flushes during periods of heavy use (schools, venues, stadiums...).

ECO 2: The urinal flushes after each use, but not always with the same amount of water.

Settings adjustable based on usage frequency.

Bluetooth control included:

Downloadable app for easy configuration of urinal functions via phone, tablet, etc.



Features

White ceramic urinal with syphonic action.

Integrated radar detection triggered only during use (the system does not detect movement around the urinal, only liquid movement on the urinal surface).

Settings adjustable via SLD04 remote control (no need to dismantle the urinal) or Bluetooth app (detection sensitivity, flush duration, periodic flush, pre-flush and post-flush, on/off...).

Powered by 6V batteries (4 x 1.5V AA alkaline), integrated 230V mains supply, or external 230V/24V transformer.

Power consumption: 6V = 3 W, 24V = 8 W.

Low battery indicator.

Economical 1L flush (adjustable from 0.5L to 3L).

Flush duration adjustable from 0.5 to 15.5 seconds.

Minimum usage time before activation adjustable from 6 to 15 sec.

Automatic flush after 6 hours of non-use.

Overflow protection.

Trap water refills after each flush.

Water pressure 1–6 bar. Flow rate 18 LPM, adjustable via stop valve.

Rear water inlet M $\frac{1}{2}$ " threaded, waste outlet \varnothing 50 mm.

Angle stop valve and filter, M1/2" coupling included.

Easy installation with supplied template.

Dimensions: W350 x H960 x D400 mm.

CE certified. Electronics guaranteed for 5 years.



Trap removable from the top

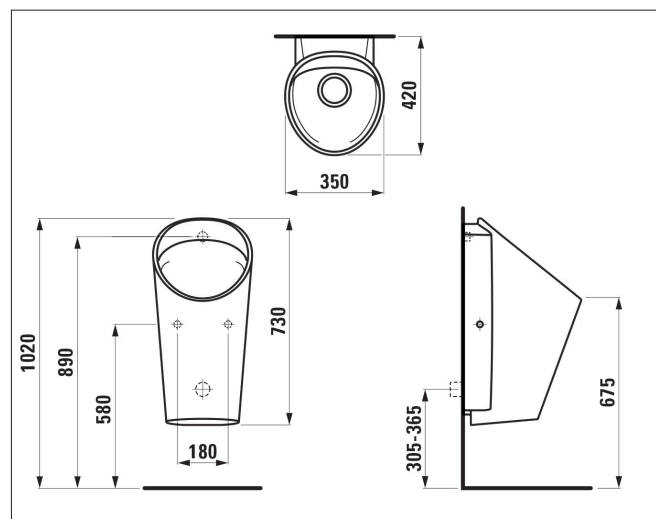

Options

- SLD04 Remote control
- SPZ06 230/24V transformer box for 1 urinal
- SPZ02 230/24V transformer box for max 5 urinals
- SPZ01 230/24V transformer box for max 9 urinals
- G241.480.00.1 1L trap kit and key
- Bluetooth application on App Store or Play Store

References model choices

LEMA automatic urinal

- **S59RZ** 230V integrated mains supply
- **S59RS** 24V external transformer
- **S59RB** battery powered

