

SUPRATECH

HYGIENE ON THE MOVE!

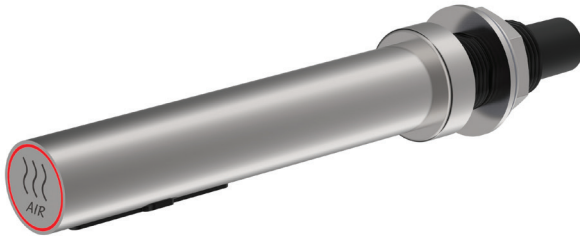

HIGH-SPEED STAINLESS STEEL HAND DRYER

INSTALLATION AND MAINTENANCE GUIDE

High-speed stainless steel hand dryer for panel mounted installation

Ref. : **SM-R20**

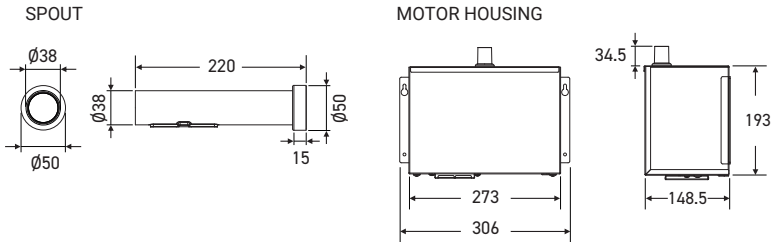

TECHNICAL FEATURES

Operating Voltage	220-240 V, 50Hz o 60 Hz frequency, 3.8 - 4.2 A, 0.84 - 1.00 kW
Air output temperature	57°C - Ambient temperature 25°C (max., adjustable)
Air speed output	93-110 m/s
Air flow	59 m ³ /h
Motor	500 W, 22-29K RPM adjustable brush type, dual ball bearing
Motor thermal protection	Auto resetting thermostat turns unit off at 95°C
Heater element	100-500 W adjustable, ON/OFF switch. Thermostat turns unit off at 85°C, auto resetting at 75°C, thermal fuse cuts unit off at 142°C
Drying time	Less than 15 seconds
Stand-by power	Less than 0,5 W
Circuit operation	Infrared automatic, self-adjusting
Sensor range	Adjustable from 100 to 230 mm, standard 130±20 mm
Timing protection	60 seconds auto shut off
Drip proof	IP35
Isolation	Class 1
Weight	5.6 kg (8.1 kg shipping weight)
Spout	Stainless steel, th. 3 mm, L220 x Ø50 mm
Motor housing	Stainless steel, th. 1.2 mm, W306 x D148.5 x H193 mm

GENERAL SAFETY INFORMATION

DANGER

- Failure to properly ground unit could result in severe electric shock.
- Electrical connection via 3-wires, with the ground wire connected to the dryer's plate.

WARNING

- Installation by qualified service personnel only.
- Use 2.5 mm² electrical cables in accordance with current standards.
- Shut off the power supply before installation or maintenance.

NOTES

- Installation of this dryer above a washbasin isn't recommended.
If installed above a washbasin, ensure there is no reflection.
- If the power supply cord is damaged, it must be replaced by the manufacturer or its distributor or a qualified agent in order to avoid any hazard. Disconnect the fixed wired only in accordance with the wiring rules.
- This device may be used by children aged 8 year or above and by persons with reduce physical, sensory or mental capabilities, or lack of experience and knowledge, provided they have been given supervision or instruction concerning the safe use of the device and understand the hazards involved.
- Children shall not play with the device.
- Cleaning and user maintenance shall not be carried out by children without supervision.

CIRCUIT DIAGRAM

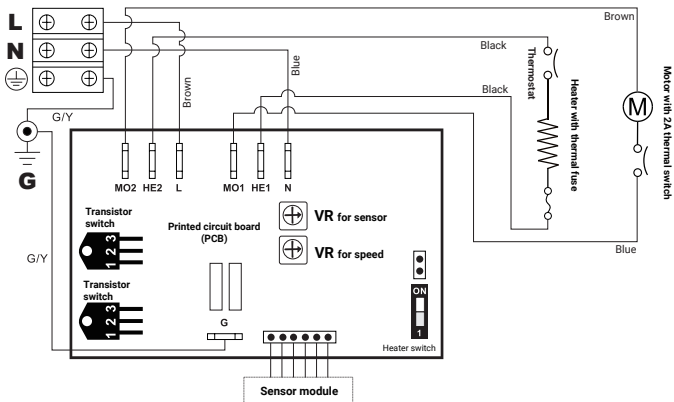

RECOMMENDED HEIGHTS

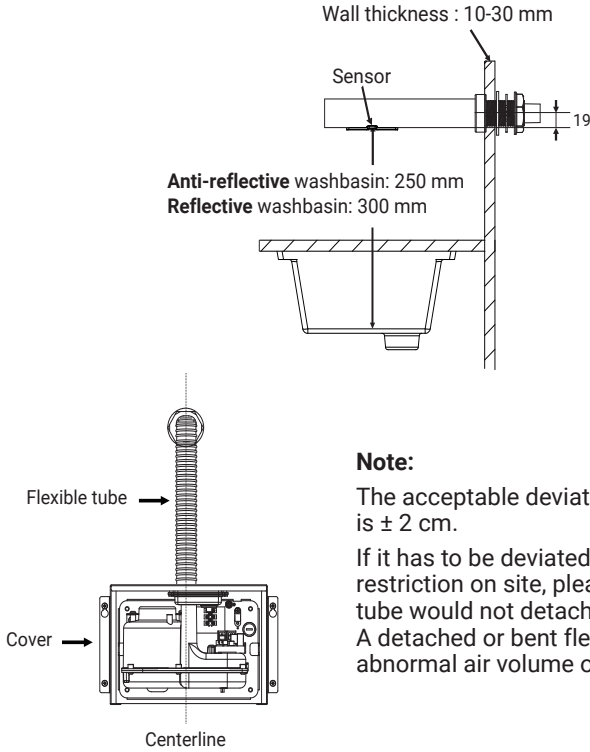

Note:

The acceptable deviation from the centerline is ± 2 cm.

If it has to be deviated for more due to restriction on site, please ensure the flexible tube would not detach or bend.

A detached or bent flexible tube may result in abnormal air volume or air speed.

MOTOR HOUSING INSTALLATION CHOICE

Service shaft installation:

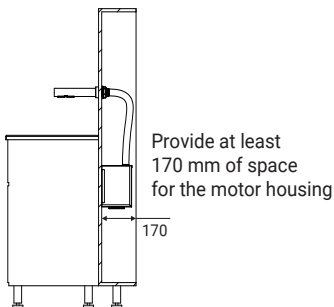

Under-washbasin installation:

An additional clearance of 170 mm in front is required for mounting the spout

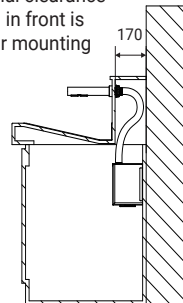

INSTALLATION

- 1** Drill a $\varnothing 35$ mm hole into the wall at the desired location

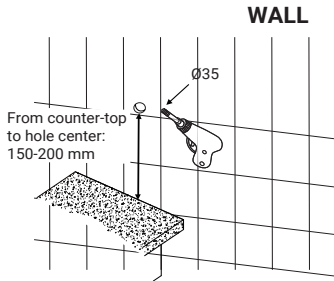

- 2** Mounting steps of the spout:
1. Insert the spout through the hole
2. Tread in the rubber pad, the anti-rotation plate and the plastic mounting nut
3. Fasten with the tool

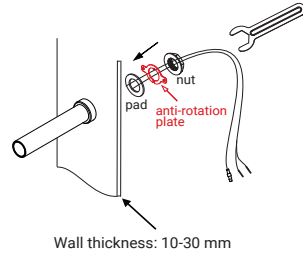

- 3** After tightening the mounting nut to the shaft of the spout, use a 2,5M hex tool to fasten and tighten the 2 M5 screws, until the screws are flush to the wall

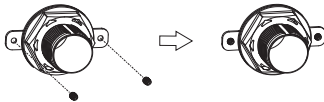

Note: to fasten the nut to the wall, use 2 M4 screws suitable for to wall type

- 4** Remove the 2 screws from the motor housing cover

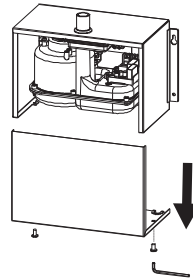

- 5** Fix the motor housing to the wall, lead the power cord through the hole in the wall and connect it to the motor

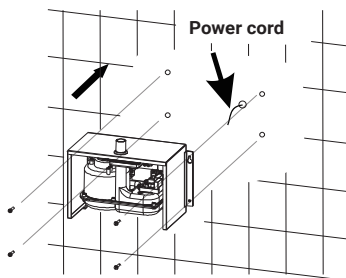

- 6** Connect the wires into the terminal:
A. Connect the live wire (colored black or dark) to the terminal block marked «L»
B. Connect the neutral wire (colored white or light) to the terminal block marked «N»
C. Connect the ground wire (colored green or yellow-green) to the screw marked «⊕»

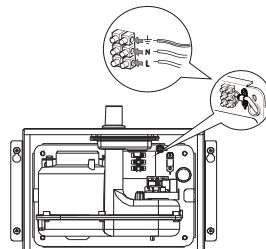

INSTALLATION

- 7** Insert the wires and the grounding wire through the flexible tube

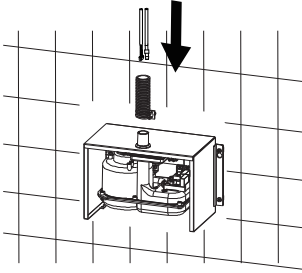

- 8** Remove the cap of the motor housing. Lead the wires and the grounding wire through the vertical air outlet. Fasten the flexible tube to the air outlet. Fasten the other end of the flexible to the shaft of the thespout

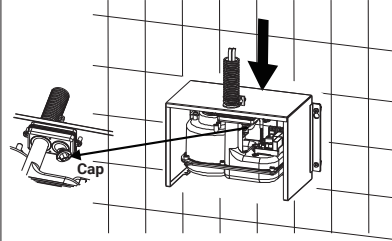

- 9** Insert the wires and the grounding wire into the cap collar and reinstall it in the motor housing

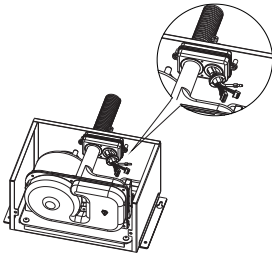

- 10** Connect the wire set (detection and LED wires) on the PCB

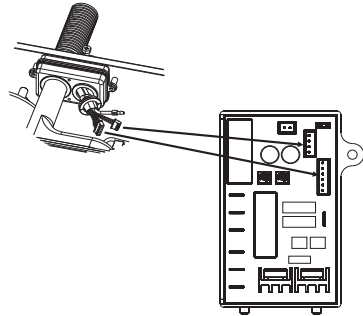

- 11** Connect the grounding wire

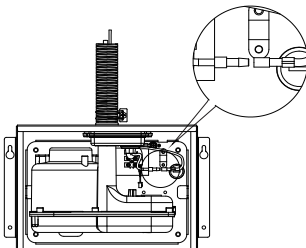

- 12** Refit the motor housing cover and tighten the 2 screws

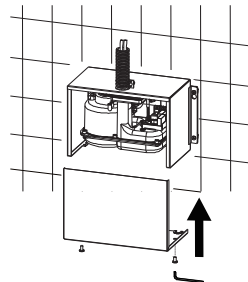

OPERATION

- Touch-free.
- Shake excess water from hands.
- Place hands under the air outlet to start operation.
- Rub hands lightly and rapidly.
- Stops automatically after hands are removed.

CLEANING AND MAINTENANCE

Regular cleaning is recommended to ensure optimum performance

- Disconnect the electrical supply.
- Remove the 2 cover-screws and the motor housing cover.
- Clean all the dust inside the motor housing.
- Wipe the spout and the motor housing cover with a damp cloth and mild cleaning solution. Do not soak.
- Never use abrasive on the spout and the motor housing cover.
- Put the cover back on. Do not over tighten the screws.

SETTING ADJUSTMENTS

Disconnect the power supply, remove the cover by unscrewing the 2 screws.

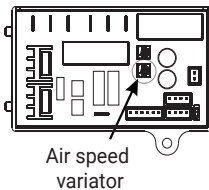

> Hot air speed adjustment

Use a small Phillips screwdriver (do not force) :

- Turn it clockwise to increase (+) ↻
- Turn it counterclockwise to decrease (-) ↻

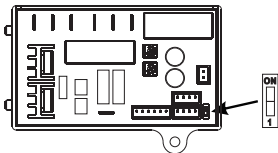

> Hot air / ambient air switch

- ON : hot air
- OFF : ambient air

It helps prevent overheating during hot periods and reduces electricity consumption.

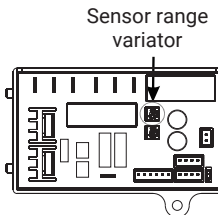

> Sensor range adjustment

Standard range 130 ± 20 mm.
Adjustable from 100 to 230 mm.

Use a small Phillips screwdriver:

- Turn it clockwise to increase (+) ↻
- Turn it counterclockwise to decrease (-) ↻

SPARE PARTS LIST

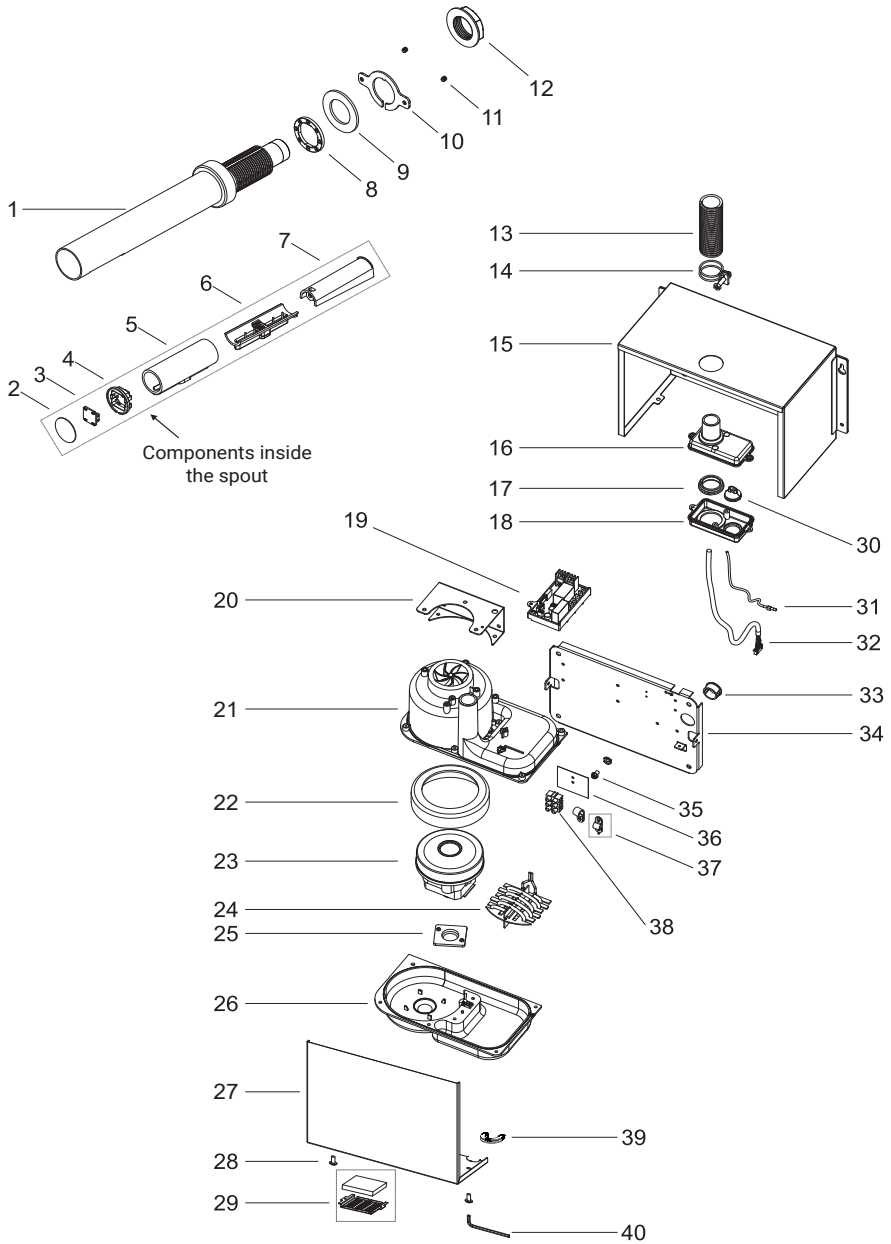

SPARE PARTS LIST

N°	DESCRIPTION	N°	DESCRIPTION
01	SS spout	25	Motor rubber pad (small)
02	Front with pictograms	26	Blower housing (bottom)
03	LED light	27	SS cover
04	LED bracket	28	Security hex screw (x2)
05	Air outlet rubber	29	Filter set
06	Sensor and air outlet	30	Wires and grounding wire cap
07	Air outlet mounting kit	31	Grounding wire
08	Spout pad	32	Sensor cable
09	Ring	33	Nylon hole bushing
10	Anti-rotation plate	34	Plate
11	Hex screw (x2)	35	Grounding screw
12	Air outlet base nut	36	Mylar insulator
13	Flexible tube (45 cm)	37	Cable clamp
14	SS collar (x2)	38	Terminal
15	SS housing box	39	Cable protection
16	Connecting box (top)	40	L key
17	Pad and cap		
18	Connecting box (bottom)		
19	Printed circuit board (PCB)		
20	Blower bracket		
21	Blower housing (top)		
22	Motor rubber pad (large)		
23	Motor		
24	Heater element		

TROUBLESHOOTING

PROBLEM	TROUBLESHOOTING FOR INITIAL INSTALLATION FAILURE
The hand dryer does not run	Ensure that the breaker supplying the dryer is engaged. If it is, isolate the power and remove the cover from the motor housing. Taking appropriate precautions to avoid shock hazard, reconnect the power and check for voltage at the block terminal. Check that the connections are made correctly.
It cycles by itself or runs continuously	Ensure that there are no obstructions in front of or on the sensor. Clean the infrared sensor. If problem persists, replace sensor.
Muffled sound or does not run for complete cycle	Ensure that the power supply is correct following the hand dryer label. The hand dryer will make a loud humming noise if the input voltage is too high. Replace damaged elements (PCB and sensor).
It runs but weak airflow	Ensure that the power supply is correct. The dryer will run weakly if the input voltage is too low. Correct the power supply as required.

PROBLEM	TROUBLESHOOTING FOR IN SERVICE FAILURE
The hand dryer does not run	Ensure that the breaker supplying the dryer is operational. If it is, isolate the power and remove the cover of the motor housing. Replace PCB and sensor. Taking appropriate precautions to avoid shock hazard, reconnect the power and check for voltage at the block terminal. Check that the connections are made correctly.
Very short detection range	Ensure that there are no obstructions in front of or on the sensor. Clean the infrared sensor. Adjust the sensor range with the variator on the PCB. If problem persists, change PCB and sensor.
The heater heats up but no airflow	Unplug the power cord. Remove the cover of the motor housing and check the speed VR. Open the blower housing. Replace the hand dryer motor.
Blows cold air	Unplug the power cord. Remove the cover of the motor housing and open the blower housing. Test the open circuit thermostat. If OFF, turn it ON. If it still blows cold air, replace the heater or PCB.
Weak airflow	Check that the air outlet is unobstructed. If there are not, unplug the cord. Remove the cover of the motor housing. Remove dust, dirt built-up on ventilation slits. Check the speed VR. Open the blower housing. Check motor brushes for wear (≤ 30 mm of graphite) and replace if necessary.

LIMITED WARRANTY

This hand dryer is covered by a 3-year warranty from the date of purchase.

If a defect is reported during the normal usage period, you are entitled, at SUPRATECH's discretion, to either replacement or repair of the defective parts due to material or manufacturing defects.

SUPRATECH will not be responsible for any labour, installation or other additional or indirect costs other than those specified above.

In no event shall SUPRATECH's liability exceed the purchase price of the product.

This warranty does not cover breakdowns due to incorrect installation or maintenance, normal wear and tear.

This disclaimer of warranty includes, among others:

- Incorrect installation.
- Improper use, modifications, defects or lack of maintenance.
- Wear parts.
- Vandalism.

Failure to comply with the safety precautions and/or installation recommendations described in this installation guide will void the warranty.

For all warranty claim, please contact your plumbing contractor, dealer or SUPRATECH directly.

Please be sure to provide all pertinent information regarding your claim:

complete description of the problem, reference and model number, proof of purchase and installation date.

IMPORTANT INFORMATION

This product falls within the scope of the Waste Electrical & Electronic Equipment Directive 2012/19/UE (WEEE) for the proper disposal of electrical waste. Electrical waste should not be disposed with household waste. Please recycle them where facilities exist.

SUPRATECH

AUTOMATED SYSTEMS - SANITARY ACCESSORIES - STAINLESS STEEL SANITARY WARE

2, rue des Cyprès - 37240 Bossée - France
Tel. +33 (0)2 47 92 23 31 - info@autosanit.com
www.autosanit.com

