

Stainless Steel Trough Urinal with Hidden Flushing Unit and integrated thermic flushing unit, 2 users

Reference: **SPN-2T**

EN ISO 9001:2015



Ref. SPN-2T

Operation

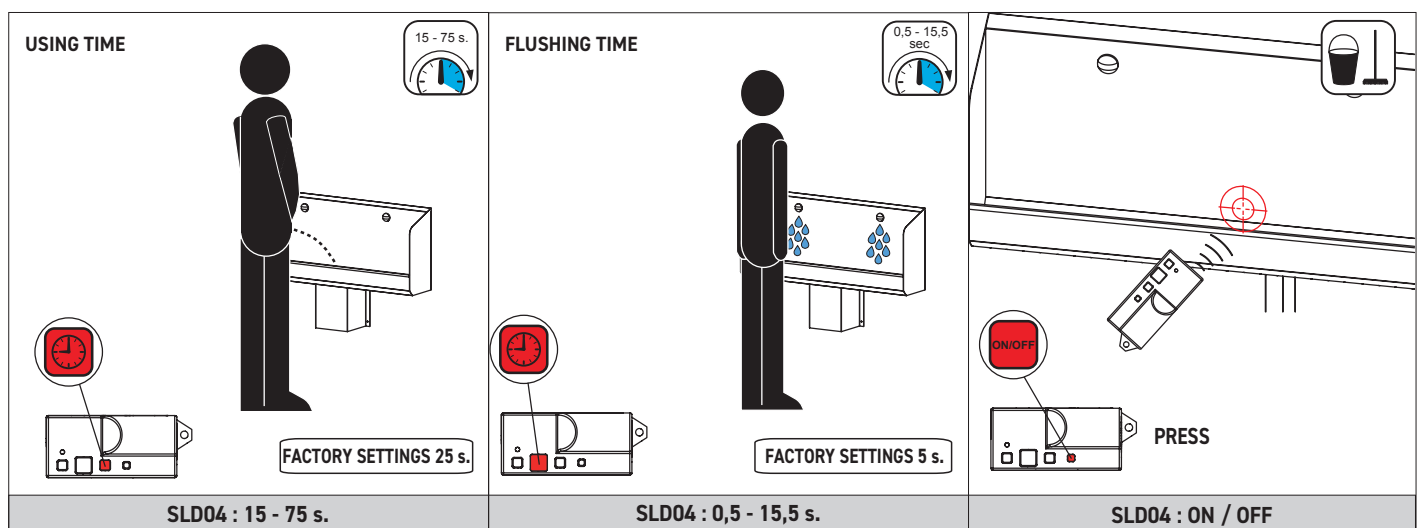
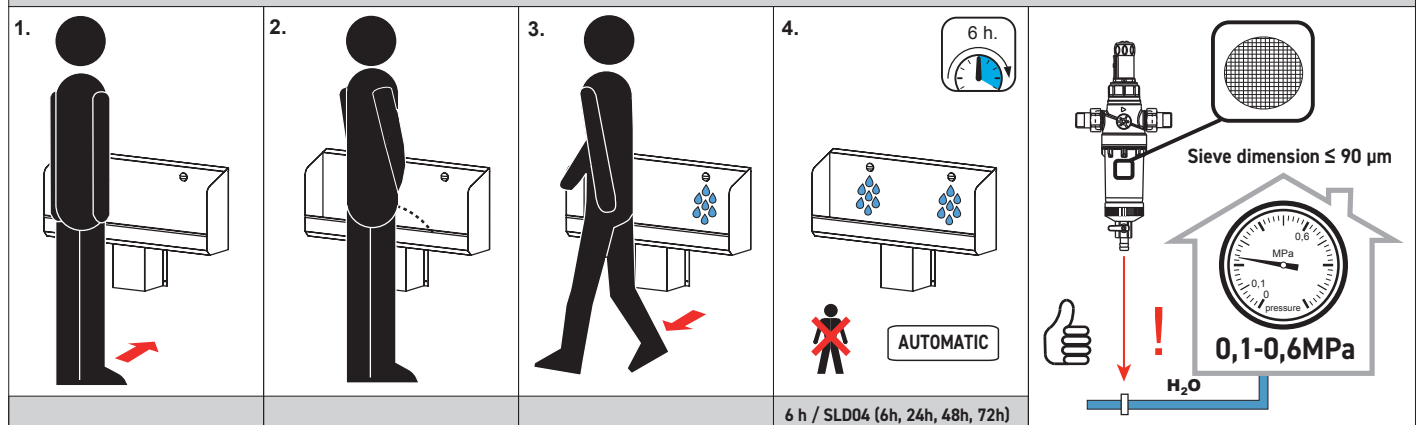

MOUNTING INSTRUCTIONS

Supplied equipment

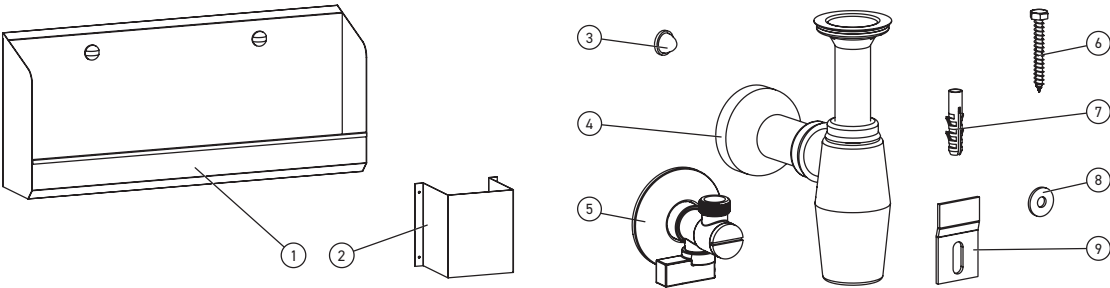

Part no.	Ref.	Quantity
1	SAN-46891	1
2		1
3	SAN-46895	1
4	SAN-46891	1
5	SAN-45938	1
6	SAN-45847	8
7	SAN-45782	8
8	SAN-45836	8
9	SAN-45780	2

Dimensions

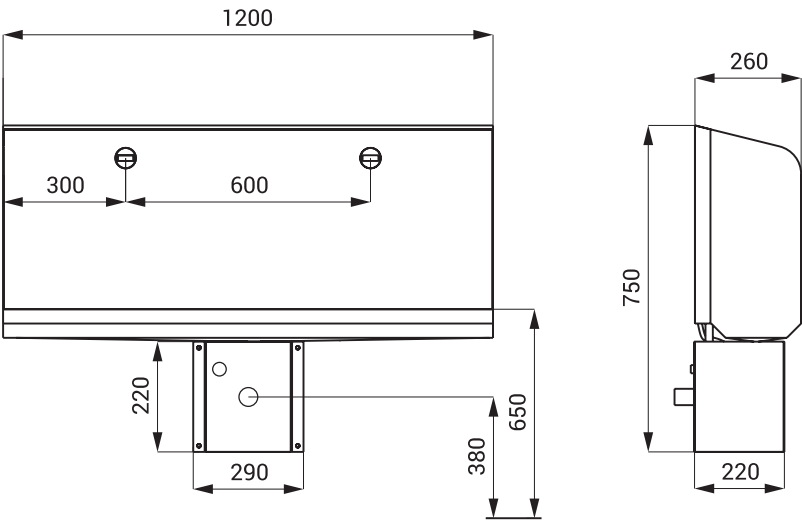

Installation

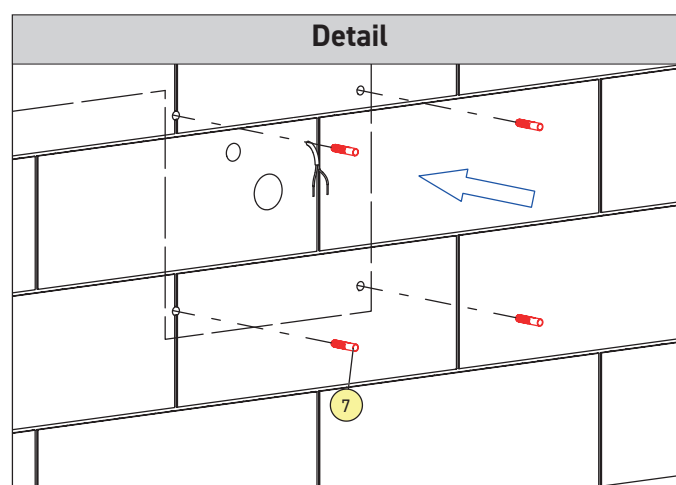
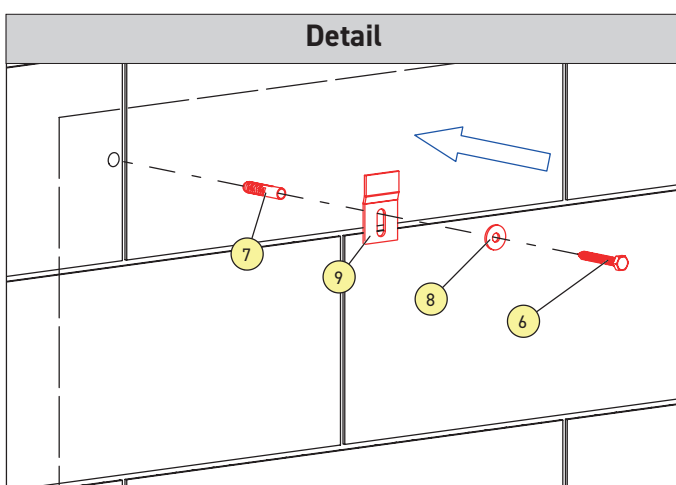
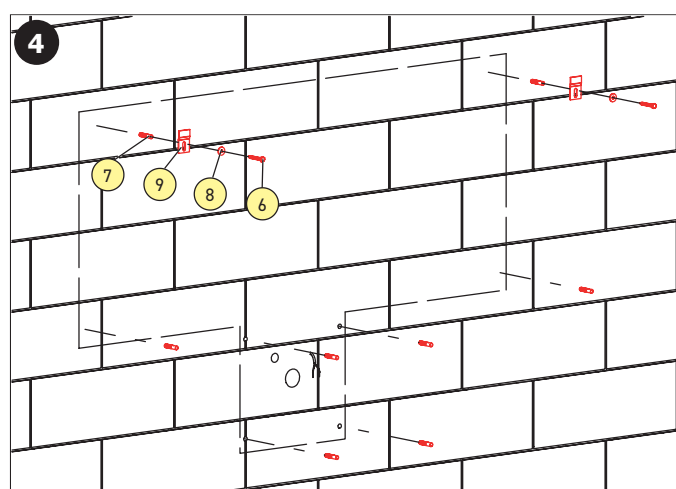
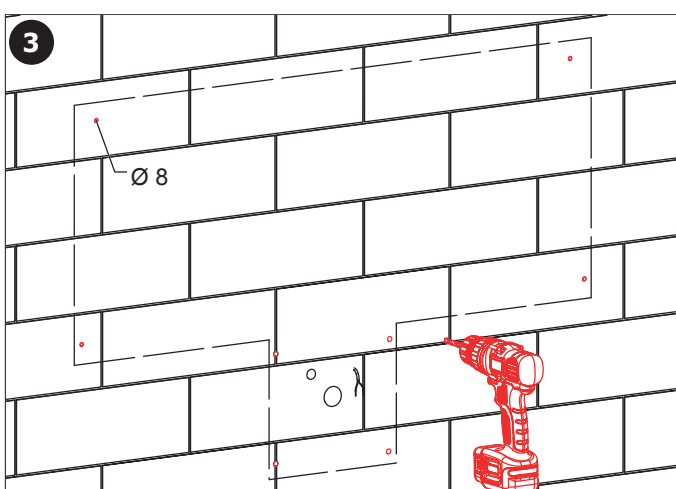
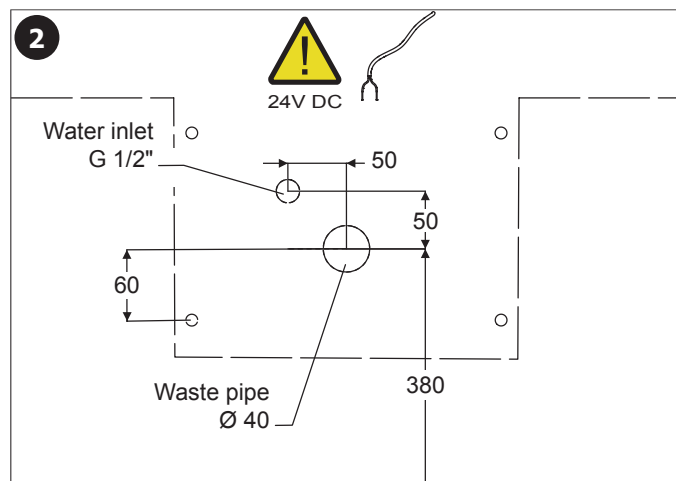
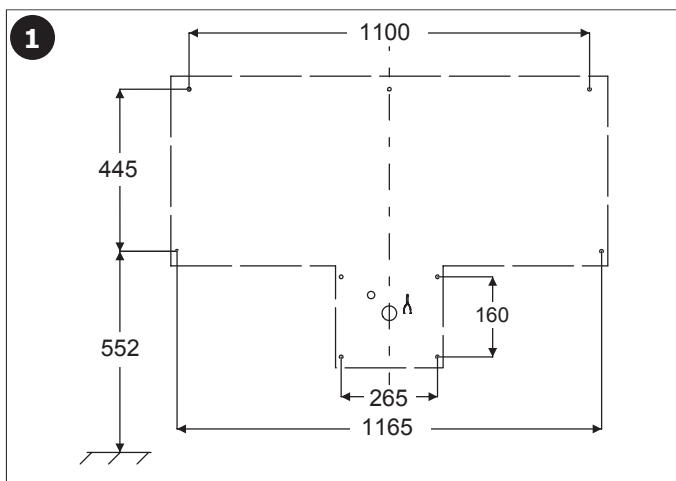

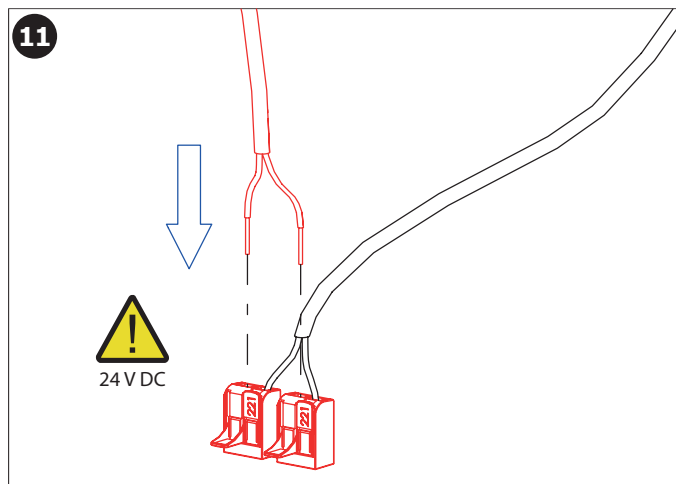
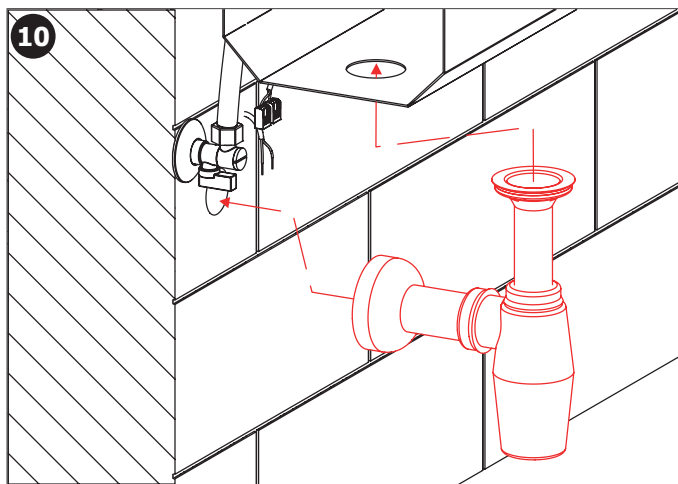
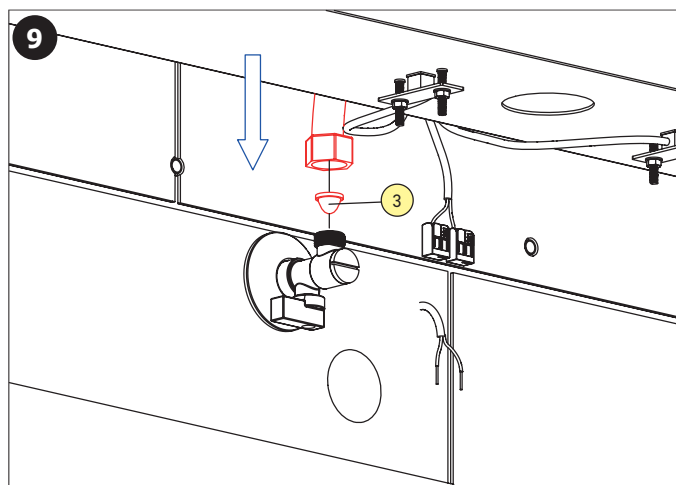
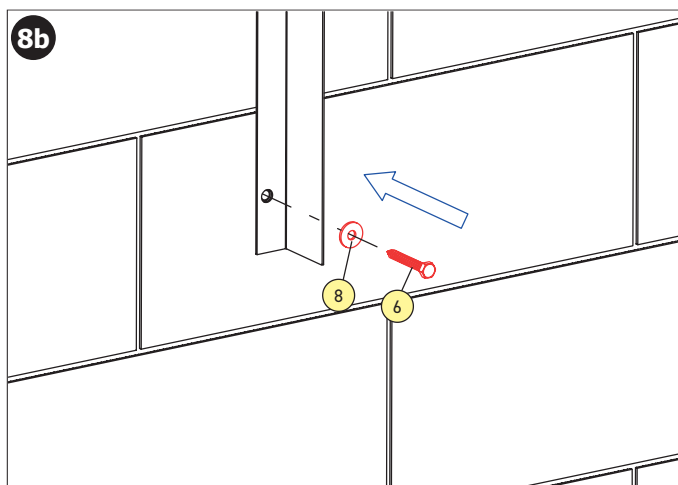
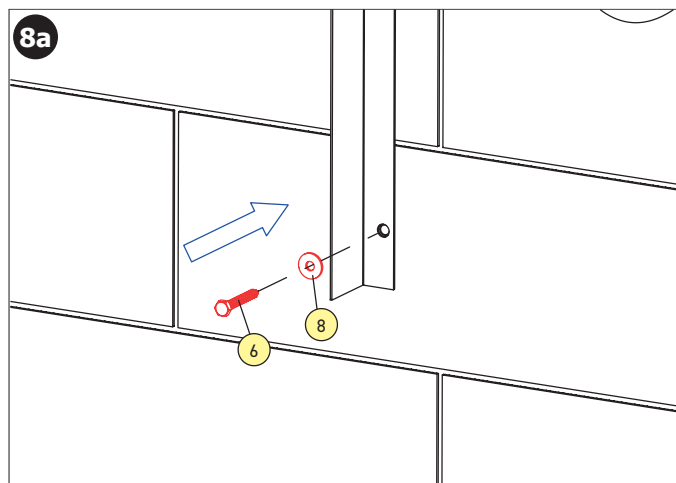
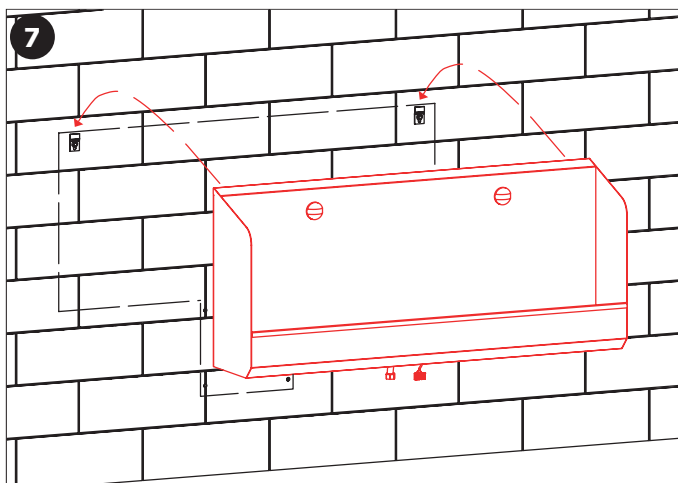
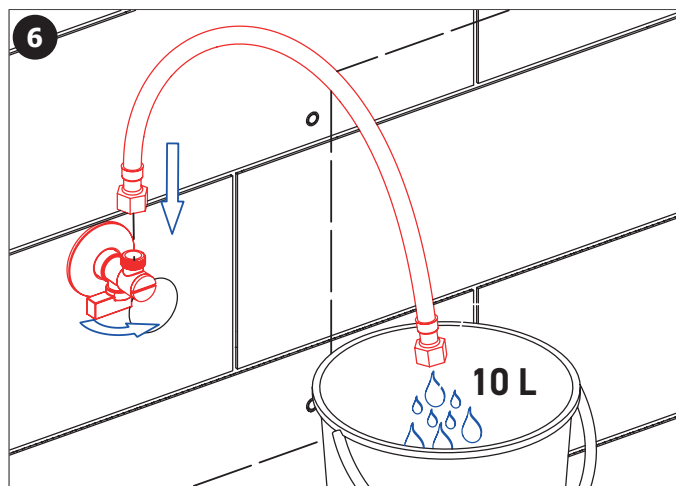
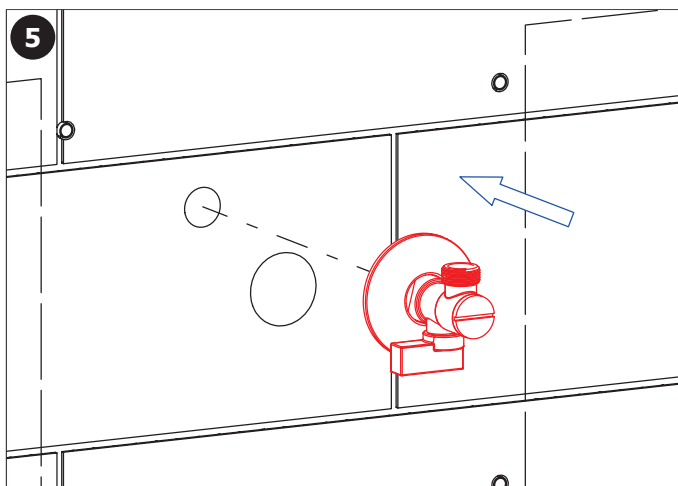

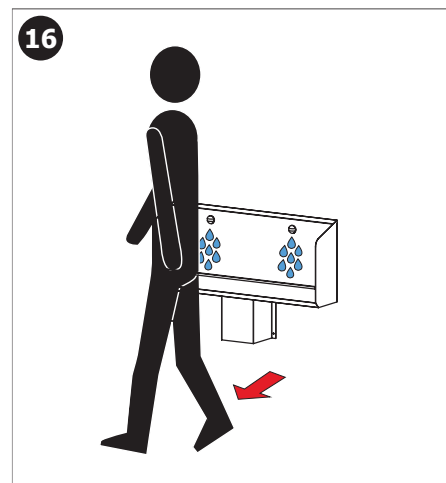
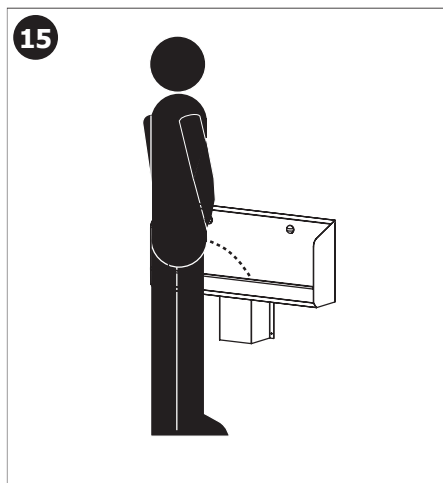
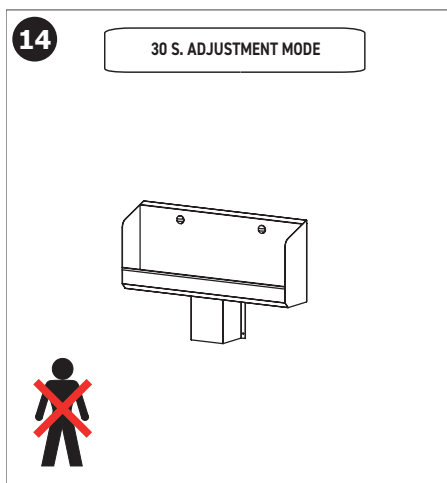
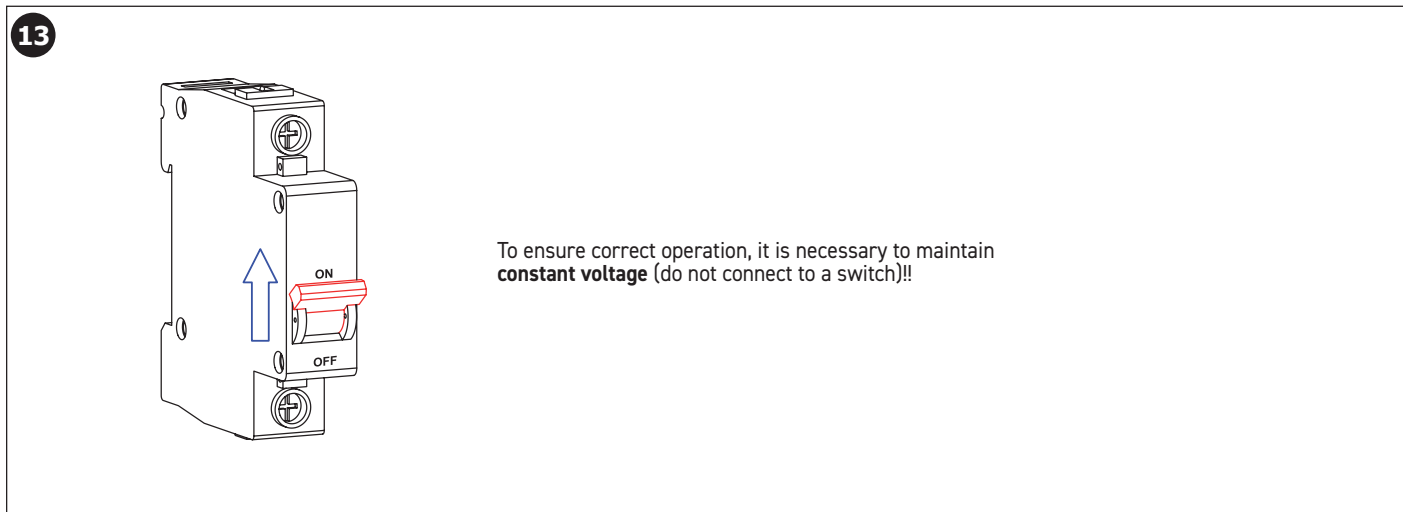
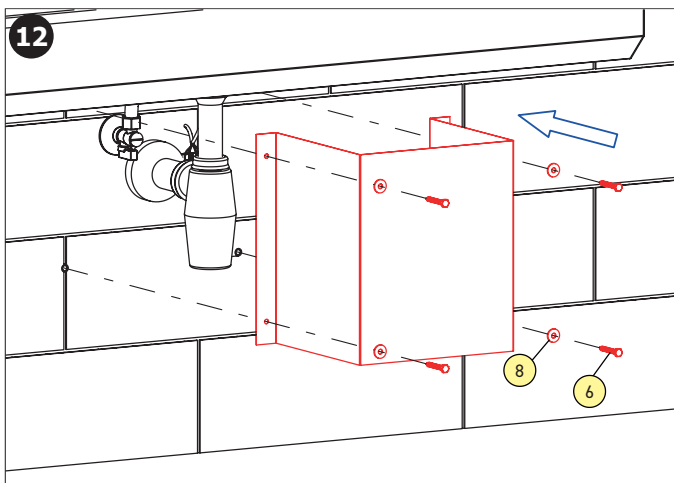

MAINTENANCE

To keep the solenoid valve clean and working properly, it is recommended that the solenoid valve filter be checked for debris/dirt once a year.

It is also recommended that the screws and wiring are checked for tightness once a year.

All stainless steel components should be cleaned with soapy water and a soft cloth **ONLY**. The use of abrasive and aggressive products are strictly prohibited!!

Packaging should be disposed of in accordance with local laws and regulations.

The manufacturer declares that this product has a declaration of conformity in accordance with regulations 73/23 EHS and 92/31 EHS.

RECOMMENDED ACCESSORIES

Ref. **SLD04** : Remote control for adjustments

Ref. **SPZ01** : 230/24V transformer box to supply up to 2 pcs. flushing units.

Ref. **SPZ02** : 230/24V transformer box to supply up to 5 pcs. flushing units.

Ref. **SPZ06** : 230/24V transformer box to supply up to 1 pc. flushing unit.