

UL-101 ASSEMBLY INSTRUCTION

1 Stage 1: Installation of finger-plates

Necessary tools:

- Sandpaper or acetone according to painted or laminated door
- 2 grips
- a drill and a drill bit Ø 6 mm (0,23")



According to door overlay:

①

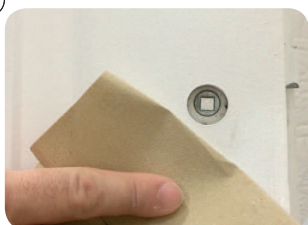

To abrade surface to be primed using sandpaper for painted door.

OR

②



To clean this same surface with acetone for a better adherence on laminated door.

③



To place square spindle in door-knob hole.

④

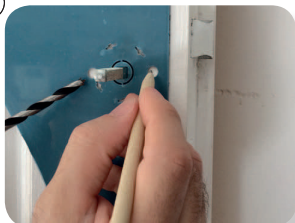

To show red side of plate (adhesive) in the square spindle, to identify the holes on both sides of this square spindle, then to carry out drilling in Ø6 mm if your lock presents the same spacing of holes envisaged for this purpose in order to allow the installation of the relay screws.

⑤



To take off the red plasticized film on the adhesive side.

⑥



To stick the finger-plate on the door by using the square spindle as an installation template.

⑦



To press on the plate in order to stick it well.

⑧



To install the 2 relay screws (if your lock allows the boring of holes).

⑨



To fix the plate on the door using grips, during at least 30 minutes, in order to optimize its adherence then, once the grips removed, to withdraw protection film.

Caution: the adherence of the plate will have reached its maximum effectiveness at the end of 72 hours. Before this time, to avoid exercising any pulling action.



**Etape 2: Installation
of mechanism (UL-059)**

2

Necessary tools:

- Flat screwdriver
- Screw driver
- White grease with lithium



To insert the square spindle.

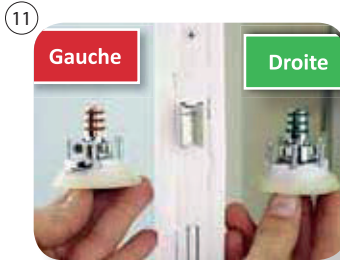

Opposite the door frame, the mechanism I with 3 red O rings is placed on the left, inserted on the square spindle stem, the arc of the circle notched in the direction of the hinge (or sheets) side of the door leaf. The mechanism with 3 green O rings is placed on the right, symmetrically with the red mechanism, the arc of circle notched facing the top of the hinge plates (or sheets) of the door.



If screwing takes place on the Ulna finger-plates, to exercise strong pressure at the time of the first screwing of each of the screws. Any failure to exercise this strong pressure could result in the plates coming unstuck and coming towards you. To renew this same process on other side of the door.

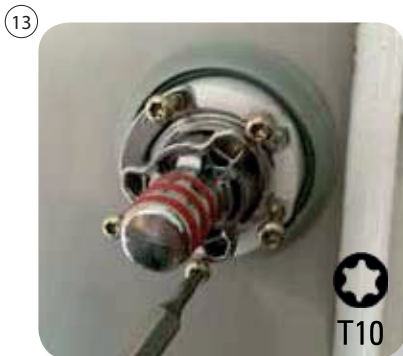

Once the mechanism placed on the square spindle, and using the screw driver equipped with the T10 end provided:

- to initially engage each of the screws to the 2/3rd of their run...

If screwing occurs on the Ulna finger-plates, to exercise strong pressure at the time of the first screwing of each of the screws. Any failure to exercise this strong pressure could result in the plates coming unstuck and coming towards you. To renew this same process on other side of the door.

- ... before total threading in a second stage.

Indeed, to fully thread the first screw (and/or the following ones) would involve not only a shift of the screws opposite the remaining holes, but could also break the white ring out of POM material.*

Caution: For maintenance and good performance of the system, to regularly repeat the greasing operation. Failing to apply this periodic greasing may result in break of the system, for which SUPRATECH cannot be held liable.

* Polyacetal (POM) is a thermoplastic material, characterized by a high solidity and rigidity. It has good sliding properties and good resistance to wear, while showing low water absorption.

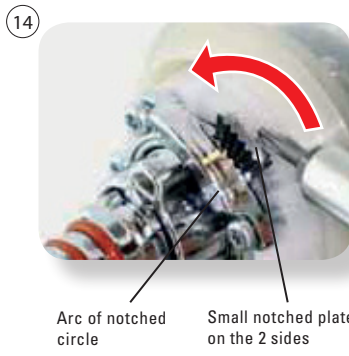

Option of adjustment of 1/2 turn: This adjustment causes to reduce accordingly the angle of movement of the handle necessary for the opening. For that, to compress the spring, so as to make it return in its compartment. To unscrew the screw located at each end of "the arc of notched circle". Using a flat screwdriver, to position "the small plate notched on both 2 sides" towards its opposed side, the spring compression being carried out as the latter is moved.

To fully thread the screw located at each end of "the arc of notched circle" all while maintaining the position of "the small notched plate on the 2 sides". To carry out the same application on the other side.

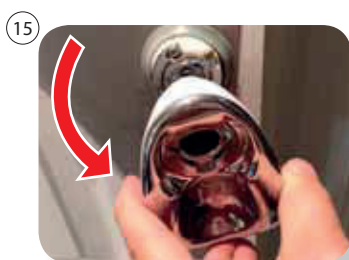

It is now possible to install the ul-101 handles by clipping them on their mechanisms, unless one has to carry out the consistent optional adjustment by adjusting one of the 9 handle positions.

Caution: Benefit from the installation to apply grease on the spring of each mechanism. For that, turn over and then introduce the UL-059 Pass white side facing the mechanism:

- in "the nut with the 3 **red** O rings", then unscrew it while **turning it anti-clockwise**. To remove this nut as well as "the nut with 3 equidistant branches". To lubricate the spring, to re-screw the whole.

- in "the nut with the 3 **green** O rings", then to unscrew it while **turning it in a clockwise direction**. To withdraw this nut like "the nut with 3 equidistant branches". To lubricate the spring, to re-screw everything.

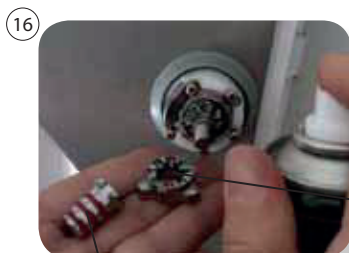

Nut with the 3 red O rings

3 Stage 3: Height adjustment of the handle red side



To unscrew by a few turns "the nut with the 3 red O rings", **while turning it anti-clockwise**.
It is not necessary to unscrew it completely.

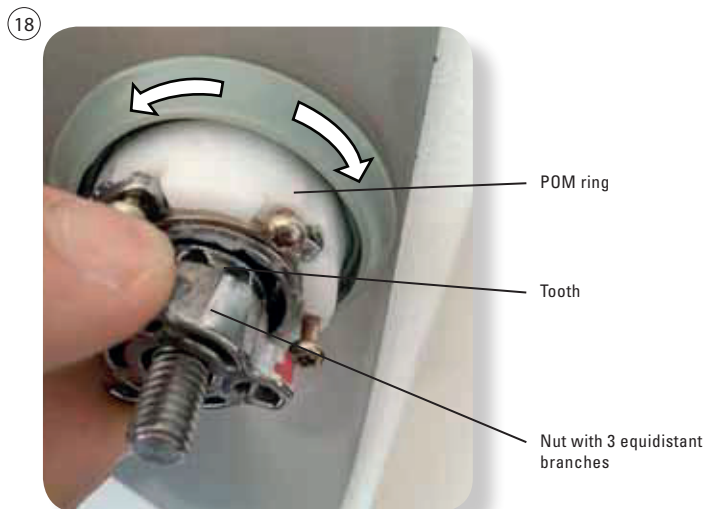

To turn "the nut to the 3 equidistant branches" - located between the POM ring in the integrated spring and the nut to the 3 red O rings -
- by 3 teeth **to the right** in order **to raise the height** of the handle by 5 cm
- or by 3 teeth **towards the left** in order **to reduce the height** of the handle by 5 cm.

To re-screw "the nut with the 3 red O rings", by screwing **in a clockwise direction**.



To clip the UL-101 handle on "the nut with the 3 red O rings". To check its height. If it is suitable, congratulations your UL-101 system is ready to be used.

If not, if it is still necessary to change this handle height, it is enough to renew this same operation by starting with unclipping the Ulna handle by showing the hollow part of the Pass in front of the egg handle, to hear a click and to apply at the same time a sudden movement of 2 or 3 "to and from" of the handle in order to disengage it completely to withdraw it.

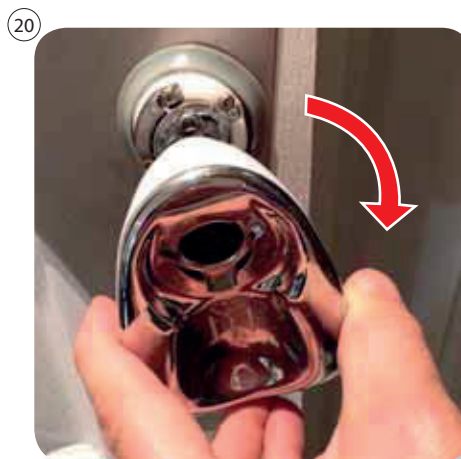

Once the right height selected, to carry out **a tight screwing** of "the nut with the 3 red O rings", while inserting it in the hole of the Pass, white side towards the mechanism, then while **turning it in a clockwise direction**.

It is possible to proceed as such up to 9 times, matching the 9 height adjustments of the handle.

Stage 3: Height adjustment of the handle green side

3

21



To unscrew by a few turns "the nut with the 3 green O rings", by **turning it in a clockwise direction**. It is not necessary to unscrew it completely.

22

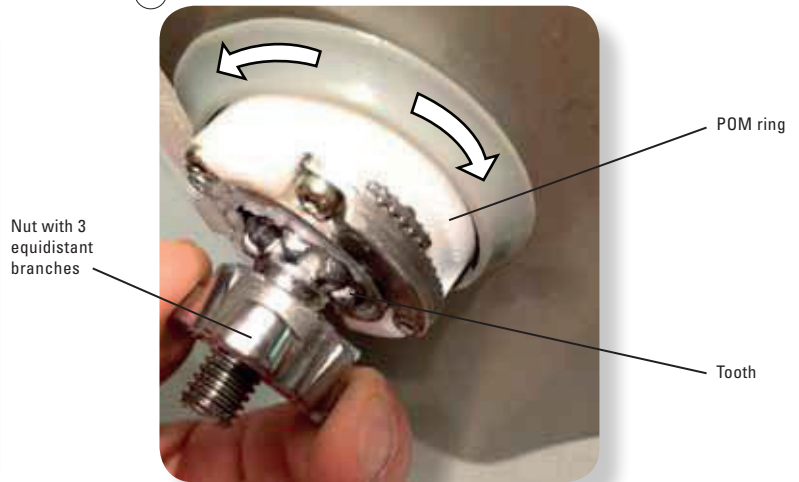

To turn "the nut to the 3 equidistant branches" - located between the POM ring of the integrated spring and the nut to the 3 green O rings -
- of 3 teeth **to the right** in order **to lower the height** of the handle by 5 cm
- or by 3 teeth **to the left** in order **to raise the height** of handle by 5 cm
To re-screw "the nut with the 3 green O rings", by **screwing it in an anti-clockwise direction**.

23



To clip the UL-101 handle on "the nut with the 3 green O rings". To check its height. If this is suitable for you, congratulations your UL-101 system is ready to be used.

If not, if it is still necessary to change this handle height, it is enough to renew this same operation by starting with unclipping the handle by showing the hollow part of the UL-059 Pass in front of the egg handle, to hear a click and to apply at the same time a sudden movement of 2 or 3 "to and from" of the handle in order to release completely to withdraw it.

24

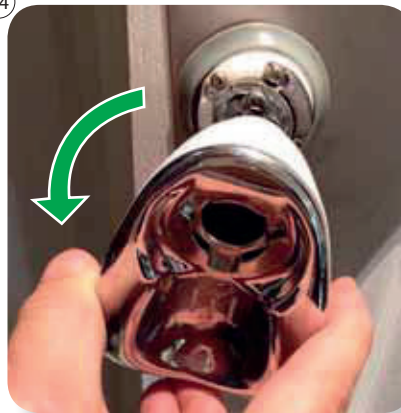

Once the right height selected, to carry out a **tight screwing** of "the nut with the 3 green O rings", while inserting it in the hole of the UL-059 Pass, white side towards the mechanism, then while turning it **in a clockwise direction**.

It is possible to proceed as such up to 9 times, matching the 9 height adjustments of the handle.

25



Finally, it is possible to adjust the handles at **a height that is equal or shifted** according to the uses for which they are intended.

For example, for a day nursery, the external handle can be adjusted in **a low position so that the children can enter** as their wish and independently.

On the other hand, the handle located inside the door could be adjusted **in a high position, accessible only to adults**.