

## UL-100 et UL-102 Silver ASSEMBLY INSTRUCTIONS



### 1 Stage 1 : Installation of finger-plates

#### Necessary tools:

- Sandpaper or acetone according to painted or laminated door
- 2 grips
- a drill and a drill bit Ø 6 mm (0,23")



#### According to door overlay:

①

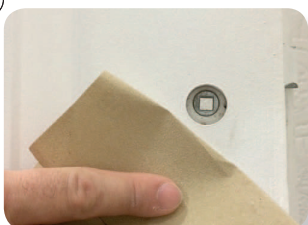

To abrade surface to be primed using sandpaper for painted door.

OR

②



To clean this same surface with acetone for a better adherence on laminated door.

③



To place square spindle in door-knob hole.

④

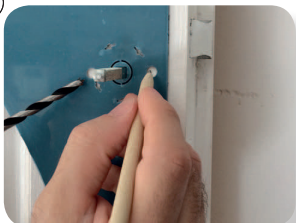

To show red side of plate (adhesive) in the square spindle, to identify the holes on both sides of this square spindle, then to carry out drilling in Ø6 mm if your lock presents the same spacing of holes envisaged for this purpose in order to allow the installation of the relay screws.

⑤

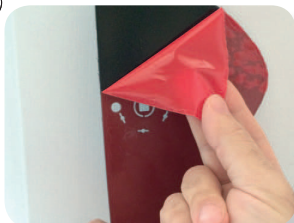

To take off the red plasticized film on the adhesive side.

⑥



To stick the finger-plate on the door by using the square spindle as an installation template.

⑦



To press on the plate in order to stick it well.

⑧



To install the 2 relay screws (if your lock allows the boring of holes).

⑨



To fix the plate on the door using grips, during at least 30 minutes, in order to optimize its adherence then, once the grips removed, to withdraw protection film.

**Caution: the adherence of the plate will have reached its maximum effectiveness at the end of 72 hours. Before this time, to avoid exercising any pulling action.**



## Stage 2 : Installation of mechanism (UL-059)

2

### Necessary tools:

- Screw driver
- White grease with lithium

10



To insert the square spindle, tunnel positioned downwards.

11



Opposite the door frame, the mechanism with a red point positioned at 9 am is placed on the left and the mechanism with the green point positioned at 3 am is placed on the right.

Once the UL-059 placed on the square spindle, and using the screw driver equipped with the T10 end provided :

- **To initially engage each of the 5 screws to the 2/3rd of their run...**

If screwing occurs on the finger plates, to exercise strong pressure at the time of the first screwing of each of the screws. Any failure to exercise this strong pressure could result in the plates coming unstuck and coming towards you. To renew this same process on other side of the door.

12



- ... **before total threading in a second stage.**

Indeed, to fully thread the first screw (and/or the following ones) would involve not only a shift of the screws opposite the remaining holes, but could also break the white ring out of POM material.\*



**Caution:** take advantage of the installation to add grease on the spring of each of the UL-059 mechanism. For maintenance and good performance of the system, to regularly repeat the greasing operation. Failing to apply this periodic greasing may result in break of the system, for which SUPRATECH cannot be held liable.

\* Polyacetal (POM) is a thermoplastic material, characterized by a high solidity and rigidity. It has good sliding properties and good resistance to wear, while showing low water absorption.

## Stage 3 : Installation of handle

3

13



To install the handle on the mechanism and the square spindle, then using the key provided, to screw the set screw with spangled head located in lower part until boring of the square spindle.

**Congratulations ! Your UL-100 or UL-102 system is now installed, it is now ready to be used !**